

The background of the cover is a grayscale photograph of a car's interior. A GPS device is mounted on the dashboard using a holder. The device has a circular antenna on top and a screen. A cable is connected to the device. The text "3 in 1 Car Holder" is overlaid on the image in a large, bold, italicized font.

# ***3 in 1*** **Car Holder**

## **User Manual**

## **Copyright**

Copyright c 2004

All rights reserved

This publication, including all photographs, illustrations and software, is protected under international copyright laws, with all rights reserved. Neither this manual, nor any of the material contained herein, may be reproduced without the express written consent of the manufacturer.

Version 1.0, March 2004

## **Trademarks**

Product names mentioned herein are used for identification purposes only and may be trademarks and/or registered trademarks of their respective companies.

### **Limitation of Liability**

While reasonable efforts have been made to ensure the accuracy of this manual, the manufacturer and distributor assume no liability resulting from errors or omissions in this manual, or from the use of the information contained herein.

## **Safety**

Most GPS software has built-in voice navigation to allow you to keep your eyes on the road while driving. If you need to study the map on your PDA, stop the car and pull into the side of the road first.

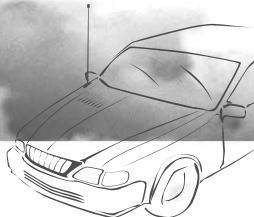

## **Table of Contents**

<b>Copyright .....</b>	<b>1</b>
<b>Table of Contents .....</b>	<b>2</b>
<b>Introduction .....</b>	<b>3</b>
<b>Components .....</b>	<b>3</b>
<b>Choosing a mounting option .....</b>	<b>4</b>
<b>Suction-support installation overview .....</b>	<b>4</b>
<b>Attaching the cradle and support .....</b>	<b>4</b>
<b>Detaching the cradle .....</b>	<b>5</b>
<b>Installing the base connector .....</b>	<b>6</b>
<b>Installing the suction-arm support .....</b>	<b>6</b>
<b>Installing the socket-arm support .....</b>	<b>8</b>
<b>Inserting your PDA .....</b>	<b>10</b>
<b>Removing your PDA .....</b>	<b>11</b>
<b>Connecting to the PDA .....</b>	<b>12</b>
<b>GPS Connector Pin Assignment .....</b>	<b>13</b>

## Introduction

Congratulations on your new purchase. The HAiCOM 3 in 1 car holder was designed to provide you with years of trouble-free use bearing your convenience in mind.

## Contents

Unpack the HAiCOM 3 in 1 car holder and check that besides this Installation Manual the following components are included:

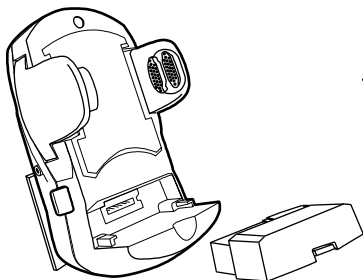

**Cradle/dummy connector**

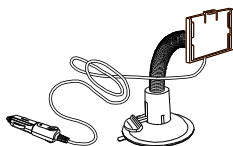

**Suction-arm support**

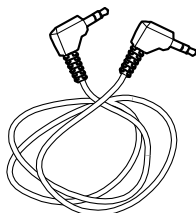

**Audio Cable**

If anything is missing or appears damaged contact the reseller.

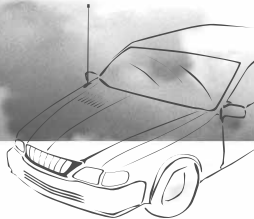

## Suction-support installation overview

The HAICOM 3 in 1 car holder comes with two mounting supports that allow the HAICOM 3 in 1 car holder to be installed in most car makes.

Use this installation option if the cigarette lighter can not be easily accessed or if you prefer to install the HAICOM 3 in 1 car holder on the dash.

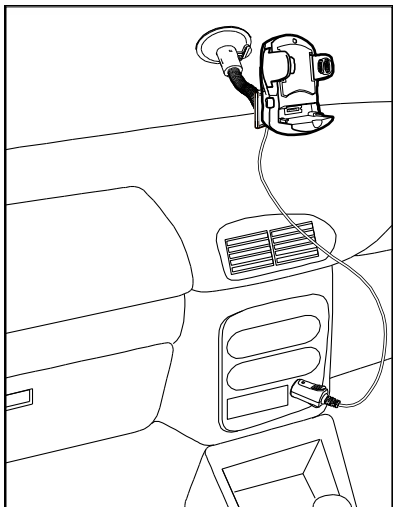

## Attaching the cradle and support

The cradle attaches in the same way to both the suction-arm and the socket-arm support. Follow these steps to attach the cradle to the support.

1. Align the cradle with the support plate as shown below.

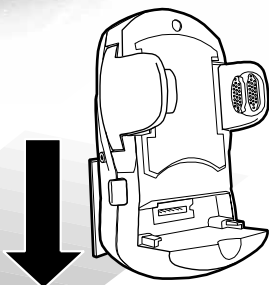

2. Insert the cradle plate into the groove on the support plate at an angle (A), and push down (B).

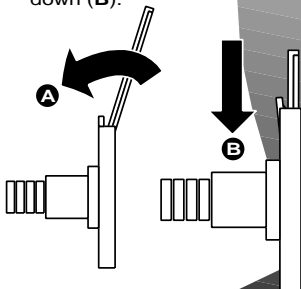
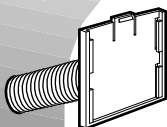

3. Push the cradle down until it "clicks" into place.

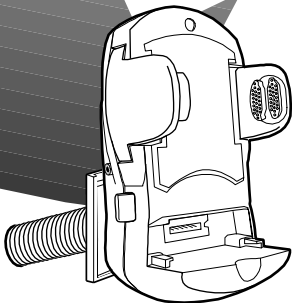



## Detaching the cradle

Follow these steps to detach the cradle from the arm fixture.

1. Pull back the tab on the cradle plate to release the support plate.
2. Slide cradle up and remove it.

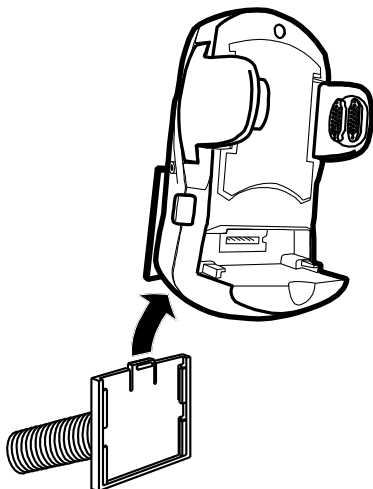
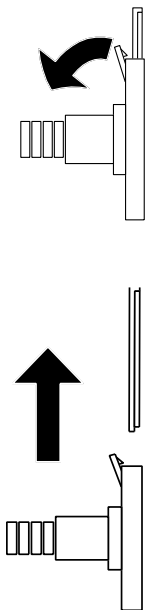

## Installing the base connector

Each brand of PDA requires a different base connector. Consult your local dealer for details on purchasing the correct base connector for your model if needed. Refer to the following to install the base connector:

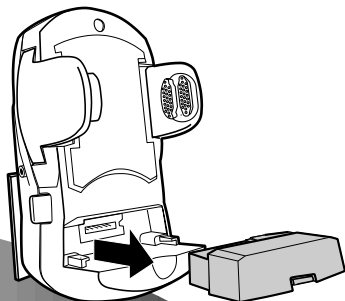
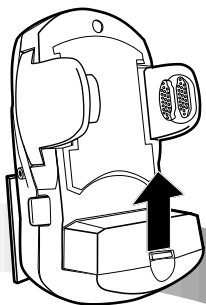

1. Release the dummy base from the cradle by lifting at tab.
2. Remove the dummy base.
3. Ensure that the connector of the new base is aligned with the socket in the cradle.
4. Insert the base connector until you hear the tab "click" shut.

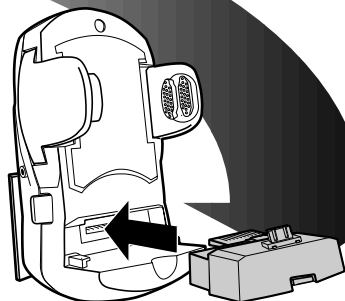



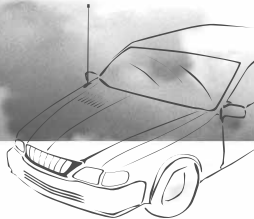

## Installing the suction-arm support

**Caution:** Turn off the car's ignition before proceeding.

The suction cup must be mounted on a clean, smooth surface, such as the windscreen, or the dashboard. Refer to the following:

1. Remove dirt or grease from the surface if necessary.
2. With the locking lever in the up position, place the suction cup on the surface.

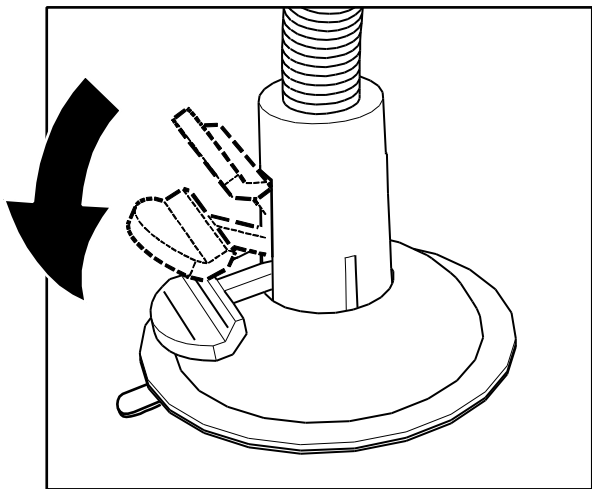

3. Push the locking lever towards the base to lock the support in place.

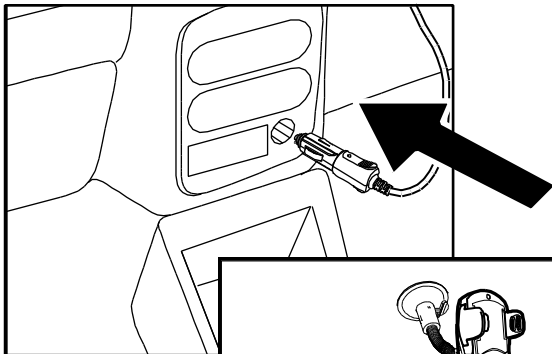

4. Insert the power adapter into the socket.

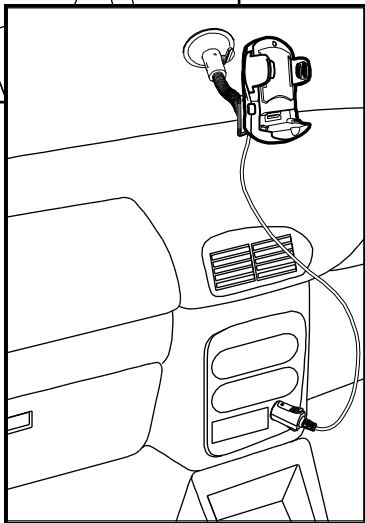



## Inserting your PDA

**Editor's Note:**

**Do you need to turn off car ignition to insert PDA?**

***Caution: Turn off the car's ignition before proceeding.***

When installed in HAICOM 3 in 1 car holder, the battery in your PDA is recharged. Refer to the following to insert your PDA into the cradle:

1. Align the PDA's connector with the connector on the cradle and push down.

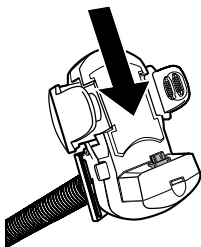
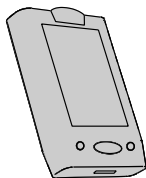

2. Press the padded arms firmly against the sides of the PDA to secure it in place.

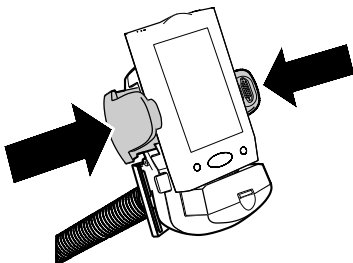

## Removing your PDA

Refer to the following to remove your PDA from the cradle:

1. Push the release button (A) on the side of the cradle to release the padded arms.
2. Lift the PDA straight up to remove it.

**Caution: Do not twist the PDA as this can cause permanent damage to the connector and/or your PDA.**

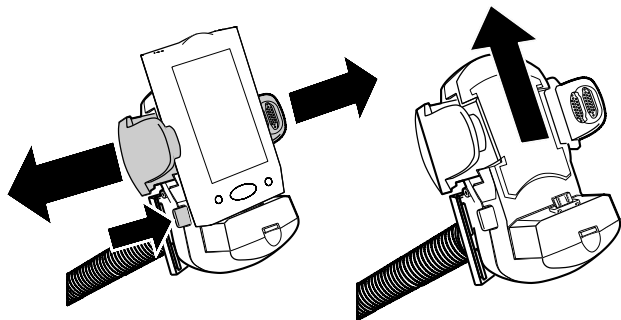
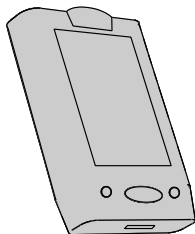

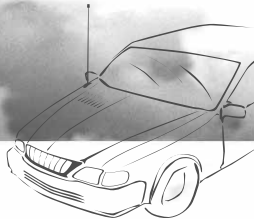

## Connecting to the PDA

You can connect the supplied audio cable from your PDA to the FreeCruiser to avail of the HAICOM 3 in 1 car holder's built-in speaker. You can connect a GPS antenna to the HAICOM 3 in 1 car holder if you have a GPS-enabled PDA.

1. Connect the supplied audio cable to the HAICOM 3 in 1 car holder (**A**) and the PDA (**B**).

2. Connect the PS2 jack from the GPS receiver to the HAICOM 3 in 1 car holder (**C**).

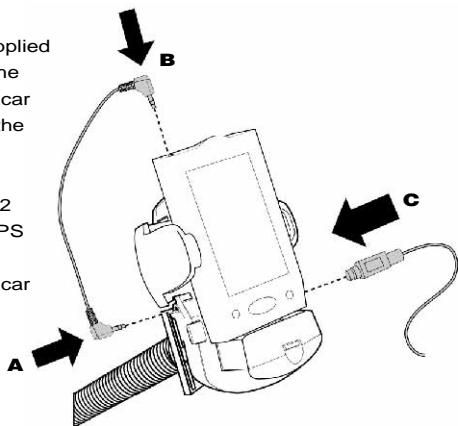

3. Position the GPS receiver on the dash or outside the car.  
**Important:** If you cannot receive signals from at least three satellites, try relocating the GPS antenna.

### Important Safety Notice:

Most GPS software has built-in voice navigation to allow you to keep your eyes on the road while driving. If you need to study the map on your PDA, stop the car and pull into the side of the road first.

## GPS Connector Pin Assignment

Ensure the PS2 connector for your GPS receiver conforms to the pin assignments shown below.

Color	Function	CN1
Green	TX	5
White	RX	4
Red	VCC	2
Black	GND	1

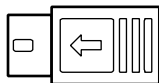
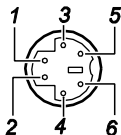

The connector is a 6-pin Mini-DIN (male) with  $3.6 \pm 0.1$  mm wire.



### IrDA Connection Installation:

Setting → System → Connect → Infrared (turn OFF) → **OK**

On test program or map, select com2 and start GPS.

PDA Speaker  
Output Plug  
(DellX5)

PDA Speaker Output  
Plug (iPAQ55xx)

Connector  
for PS/II GPS  
Receiver

GPS  
Receiver

To 12V DC  
Cigarette Lighter

IrDA  
Plug-In

PDA Speaker  
Output Plug

PDA  
Connector

Power on LED

IrDA Transceiver

Speaker

Holder Speaker  
Input Plug

Clip-on Design

PS/II Connector  
for GPS Receiver

Changeable  
PDA Connector

IrDA for iPAQ19xx PDA

